

VOLTAGE CURRENT SOURCES 20V 200mA – VIS

- PRECISION FLOATING VOLTAGE/CURRENT SOURCE UP TO 4 CHANNELS
- USE OF CALIBRATED 19BIT DAC WITH LOW TC VOLTAGE REFERENCE
- USB INTERFACE WITH PC - ISOLATED RS232C FOR FULL SETTING & STATUS READ – BIT RATE UPTO 115.2K BIT/S
- MAJOR PERFORMANCE PER CHANEL (TA:25±5°C AC:100±10V WARMUP:0.5H)

	SET	ACCURACY
VOLTAGE MODE 20V RANGE	± 0.001V - ±20.000V	< (0.02% OF SETTING + 0.5 mV)
STEP	100uV	
4V RANGE	± 0.0002V - ±4.0000V	< (0.02% OF SETTING + 0.1 mV)
STEP	20uV	
CURRENT LIMIT SET	± 1 - ± 200mA	< 1.0% OF SETTING (TRIP POINT)
STEP	1mA	
TEMPERATURE DRIFT	< 25PPM	
CURRENT MODE 200mA RANGE	±0.01mA - ±200.00mA	< (0.03% OF SETTING + 5 uA)
STEP	1uA	
40mA RANGE	±0.002mA - ±40.000mA	< (0.03% OF SETTING + 1 uA)
STEP	0.2uA	
VOLTAGE LIMIT SET	± 1V - ± 20V	< 1.0% OF SETTING (TRIP POINT)
STEP	1V	
TEMPERATURE DRIFT	< 25PPM	
SPEED	INTERFACE	INSTRUCTION RECEPTION(4 BYTE) → ACK SEND(1 BYTE)
	Tcv	1mV → FS OF 99.9% CL ≤ 100u RL ≥ 100Ω SLOW MODE
		CL ≤ 5u RL ≥ 100Ω FAST MODE
	Tcc	0.01mA → FS OF 99.9% CL ≤ 50u RL ≥ 100Ω SLOW MODE
		CL ≤ 5u RL ≥ 100Ω FAST MODE

(NOTE FAST MODE ONLY THROUGH INTERFACE)

- PROTECTION OVER VOLTAGE OVERHEAT
- AC POWER / DIMENSION 90 – 260V VIS01=1CH:W210mm H113mm D280mm VIS02=2CH:W260mm H113mm D280mm
VIS03=3CH:W370mm H113mm D280mm VIS04=4CH:W430mm H113mm D280mm
- ATTACHMENTS AC CABLE INSPECTION REPORT CDROM INCLUDING OPERATION /ASSEMBLY INSTRUCTION MANUAL
INTERFACE INSTRUCTION MANUAL / SAMPLE CODE

VI SOURCE BENCH MARKING

REFERENCE TO PRODUCT DATA SHEET

SIMILAR PRODUCT	MODEL		VOLTAGE RANGE	CURRENT RANGE
	EW	VIS01	20V - 4V	200mA - 40mA
	ADVANTEST	R6144	32V - 16V - 1.6V - 0.16V - 0.016V	160mA - 16mA - 1.6mA
	YOKOKAWA	7651	32V - 12V - 1.2V - 0.12V - 0.012V	120mA - 12mA - 1.2mA

BEST RESOLUTION	MODEL	VOLTAGE SET	CURRENT SET
	VIS01	20uV	0.2 uA
	R6144	1 ova	0.1 uA
	7651	0.1uV	0.1 nA

ACCURACY IN COMPARABLE RANGE														
MODEL	VOLTAGE SET				CURRENT LIMIT SET			CURRENT SET				VOLTAGE LIMIT SET		
	FS	STEP	ACCURACY	TC	FS	STEP	ACCURACY	FS	STEP	ACCURACY	TC	FS	STEP	ACCURACY
VIS01	20 V	0.1mV	0.02% + 0.5mV	25PPM	200 mA	1mA	1%	200 mA	1 uA	0.03% + 5uA	25PPM	20V	1V	1%
R6144	16 V	1 mV	0.03% + 2 mV	20PPM + 40uV	160mA	?	10%+ 1mA	160 mA	10uA	0.04% + 30uA	20PPM + 0.4uA	28V	?	5% + 0.1V
7651	12 V	0.1mV	0.016% + 0.24mV	8 PPM + 10uV	120mA	1mA	?	120 mA	1 uA	0.03% + 5uA	20PPM + 1uA	30V	1V	?

SPEED - CV MODE #1		
MODEL	RATING	LIMITER
VIS01	< 5mS : CL <= 5u < 60mS : CL <= 100u	DYNAMIC
R6144	< 30mS : CL <= 30u < 60mS : CL <= 100u	MAX.
7651	< 10mS : RESISTIVE (NO CL)	KILLED

FUNCTIONALITY									
MODEL	FLOATING	KELVIN	INTERFACE	EXT. PORT	SWEEP/STEP	SAVE/RECALL	PROTECTION		
VIS01	YES	YES	USB	NONE	T/I #2	YES	OVD OVC OVH		
R6144	NO	YES	GPIB , BCD	BNC INPUT	PANEL or T/I	YES	NONE		
7651	NO	YES	GPIB	BNC INPUT	PANEL or T/I	YES	OVD OVC		

#2 VIS01 : SPEED SWITCHABLE ONLY THROUGH 232C ACCESS
PANEL ACCESS ONLY SLOW MODE

#2 T/I : THROUGH INTERFACE

INTERFACE ACCESS	
MODEL	RATING
VIS01	< 1.0mS (B/R : 115.2K B/S)
R6144	< 5.0mS (GPIB)
7651	?

L/C LOADING		
MODEL	CL	LL
VIS01	FAST : < 15u SLOW : < 200u	< 200uH
R6144	< 1000uF	< 1mH
7651	?	?

MODEL	NO. OF CH	AC POWER		OPERATING TEMP.	DIMENSION	PRICE
		VOLTAGE	VA			
VIS01	1	90 - 260V	35	5 °C - +40°C	W210mm H113mm D280mm	120KYEN
VIS02	2		60		W260mm H113mm D280mm	220KYEN
VIS03	3		90		W370mm H113mm D280mm	320KYEN
VIS04	4		120		W430mm H113mm D280mm	420KYEN
R6144	1	90 - 240V	27	0 °C - +50°C	W240mm H88mm D350mm	220KYEN
7651	1	90 - 230V	30	5 °C - +40°C	W213mm H100mm D380mm	275KYEN

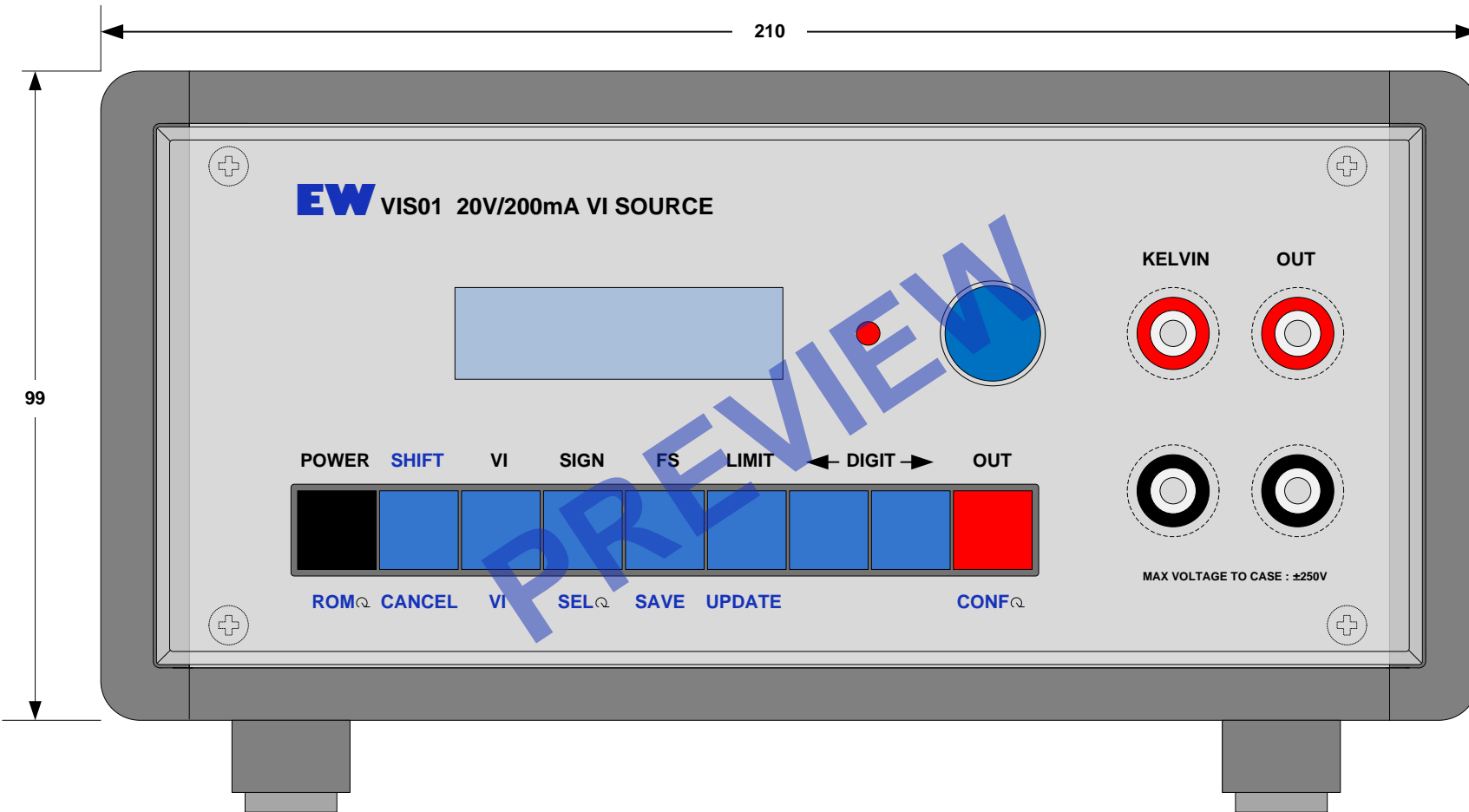

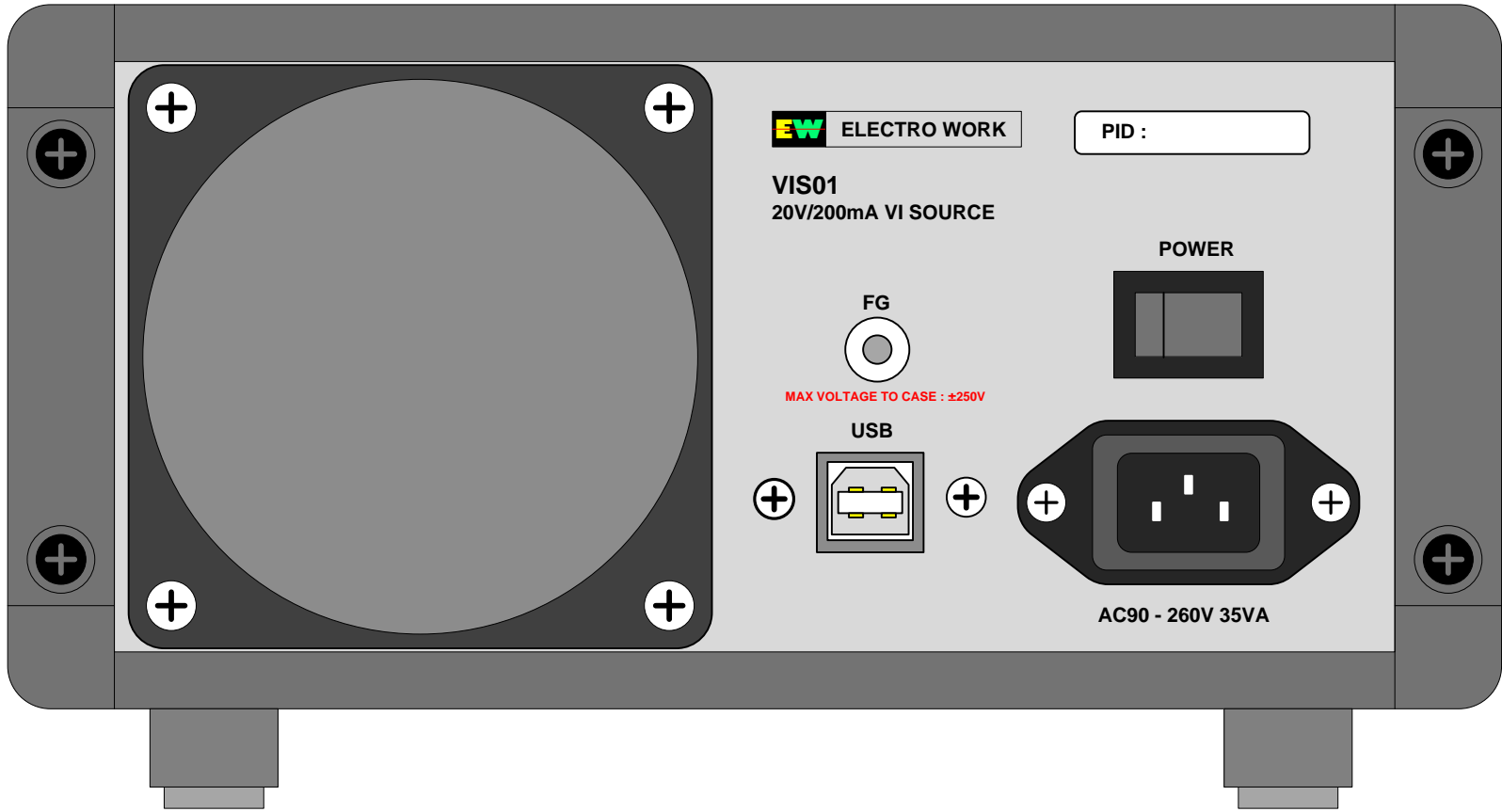

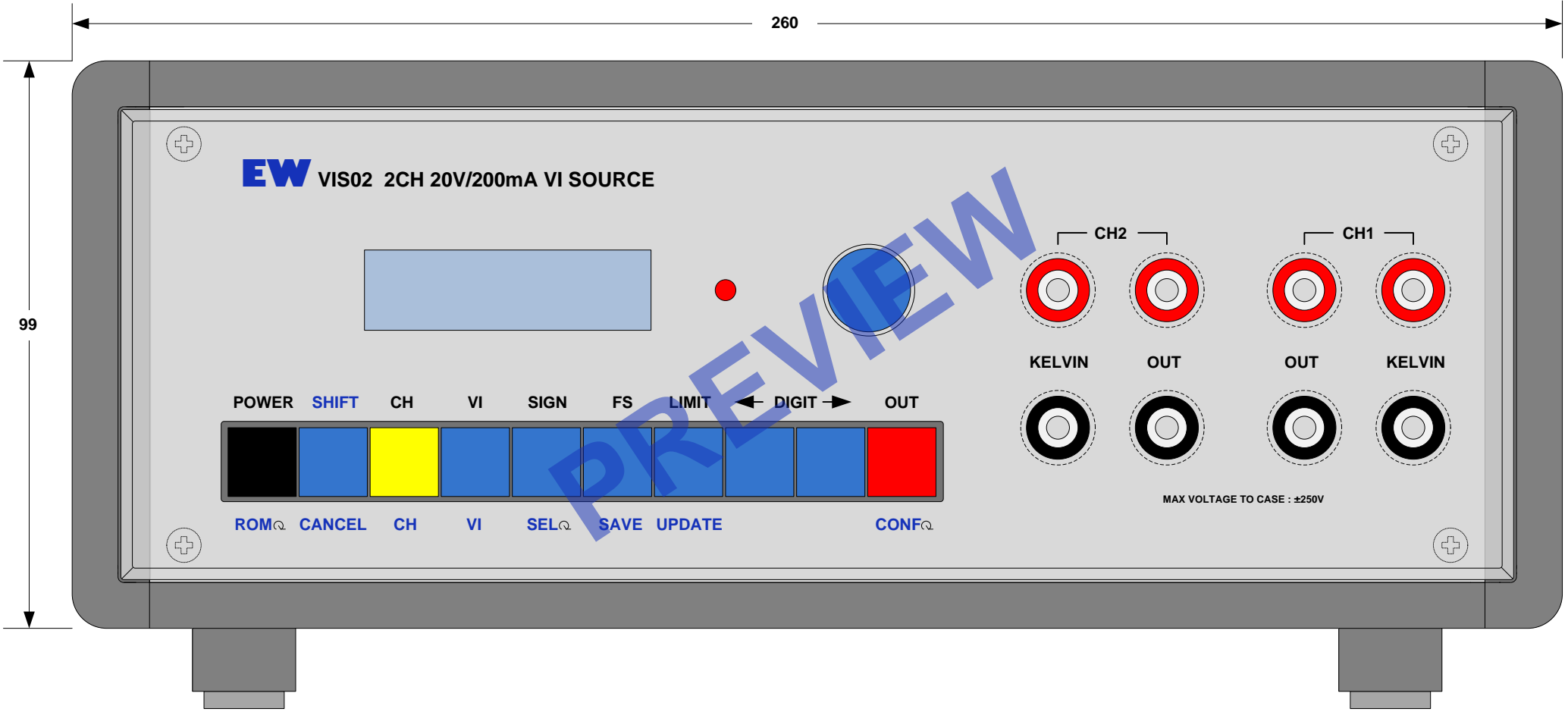

EW VIS02 2CH 20V/200mA VI SOURCE

POWER SHIFT CH VI SIGN FS LIMIT ← DIGIT → OUT
ROM CANCEL CH VI SEL SAVE UPDATE CONF

CH2
KELVIN OUT
CH1
OUT KELVIN

MAX VOLTAGE TO CASE : ±250V

